



A TRAINING AND DEPLOYMENT PLATFORM FOR INDIGENOUS PEOPLES

THE LOCATION OF CEBIPAM



Benjamin Constant

A City located on the border between Brazil, Peru and Colombia



The Time Line of CEBIPAM



August
2016



Beginning of the Vision
First meeting in the
South of Brazil

First Visit to the Amazon
Training Proposal and
meeting with leaders

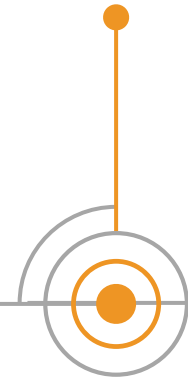

March
2017

November
2017

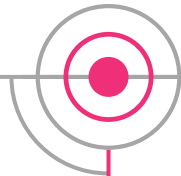

CEBIPAM Begins
First class with 35
local students

Legal Registration
CEBIPAM is registered as a
Non-Prof Organization

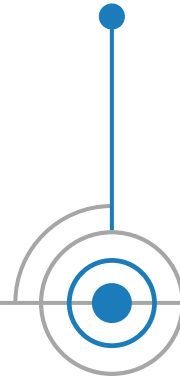

July
2019

January
2020



Building Proposal
Arquitectural Project
and logistical plan

Construction Begins
The foundation is laid

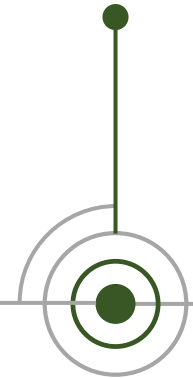

May
2020



The training given by CEBIPAM to ecclesiastical leaders among the Amazonian peoples aims at the biblical and spiritual strengthening of the local church so that it actively participates in the expansion of the gospel among the unreached peoples.

SOME OF THE AMAZON REGION'S CHALLENGES

Of every ten
pastors in the
Amazon region,
only one has
biblical training.

Few workers



Growth of Sects and Cults



Great number of isolated tribes



Difficult access to communities



Low investment



HOW CEBIPAM IS RESPONDING TO THE CHALLENGE

Currently, CEBIPAM is training 45 local leaders through the formation program.

To Foster Unity



To Enlarge the Vision



To Have a Presence in the Region



To provide Tools to Workers



To Train Leaders



HOW DOES CEBIPAM WORK?

LOGISTICS

- CEBIPAM has been using a facility of a local organization in the Amazon for its training program.

PROGRAM

- The material used is provided by BTCP and the program lasts for 3 years.

TEACHERS

- Capable pastors and leaders give classes in person in every module.

STUDENTS

- Indigenous pastors and leaders from different parts of the Amazon Region.



CEBIPAM BUILDING PROJECT



CEBIPAM is building a facility that will serve as a training base and sending platform for the indigenous leadership, in order to see the expansion of the gospel to the most remote areas of the Amazon Region.

LAND WITHIN THE TIKUNA TRIBE



Land size - 65x115 ft.
The land is located in the Tikuna village
within the Santo Antonio Community
on the banks of the Amazon River.



The donor of the land
(evaluated in \$5,000.00) with
the architect responsible for
the building project.

ARCHITECTURAL PROJECT

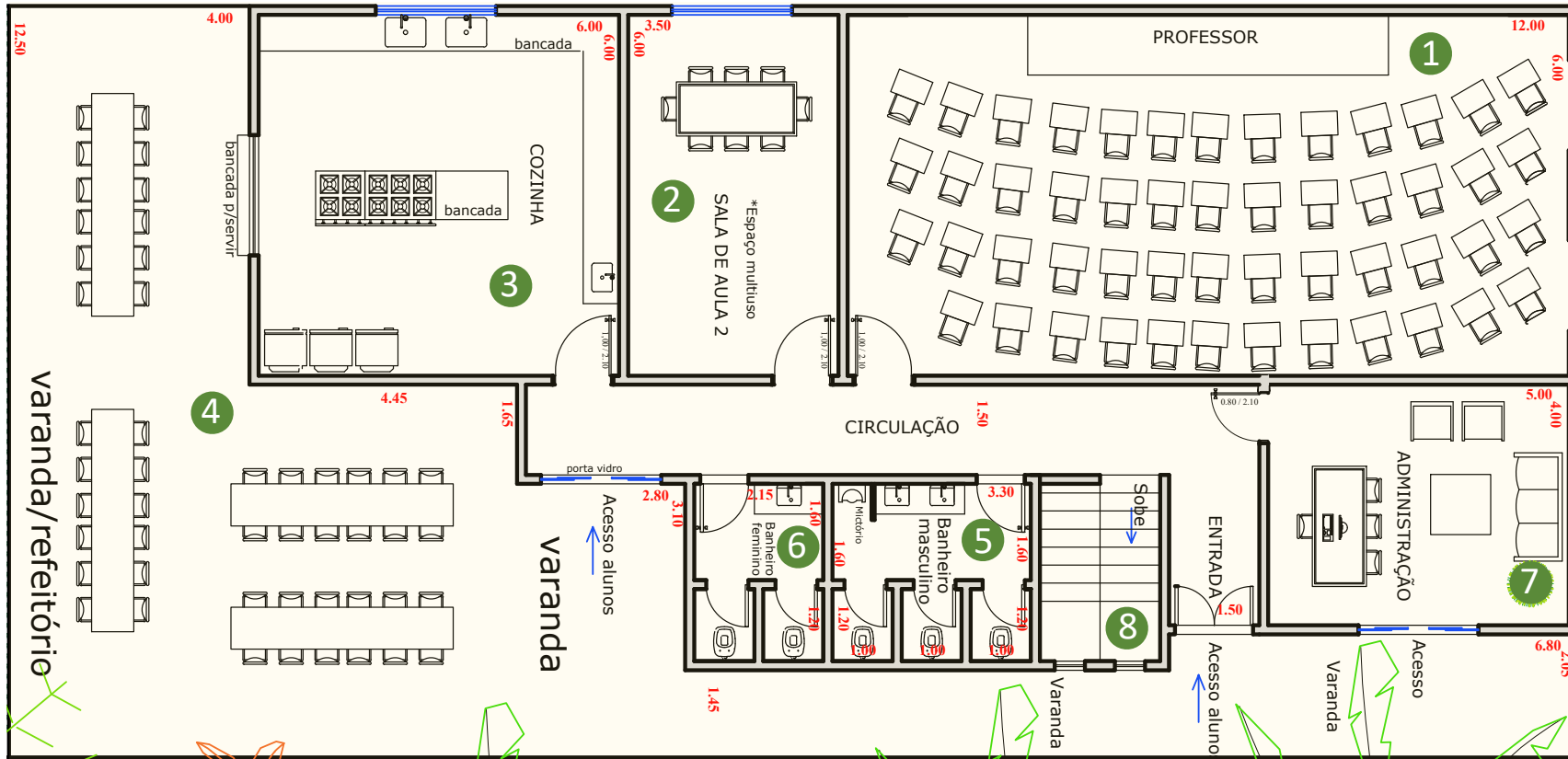

DISTRIBUTION OF THE SPACE

- 1 Classroom
- 2 Multipurpose room
- 3 Kitchen
- 4 Dining Hall
- 5 Male Bathroom
- 6 Female Bathroom
- 7 Office
- 8 Stairs

Ground Floor

ARCHITECTURAL PROJECT

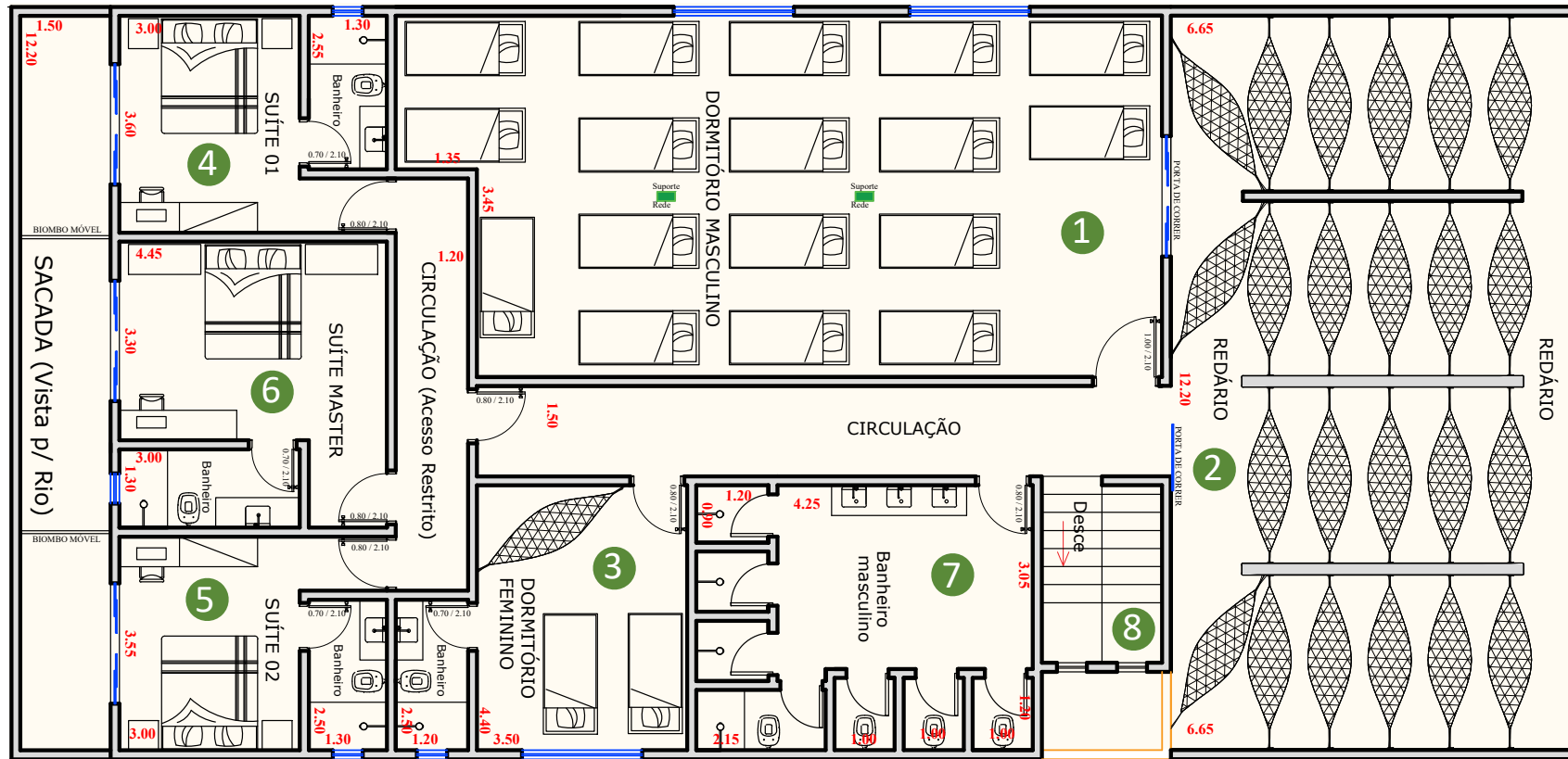

DISTRIBUTION OF THE SPACE

- 1 Bed Dormitory
- 2 Hammock Dorm
- 3 Women's Dorm
- 4 Teacher's Bedroom 1
- 5 Teacher's Bedroom 2
- 6 Main Bedroom
- 7 Bathroom
- 8 Stairs

First Floor



EXTERNAL VIEW

Frontal part of the building



Dining Hall

Bedroom's Balcony

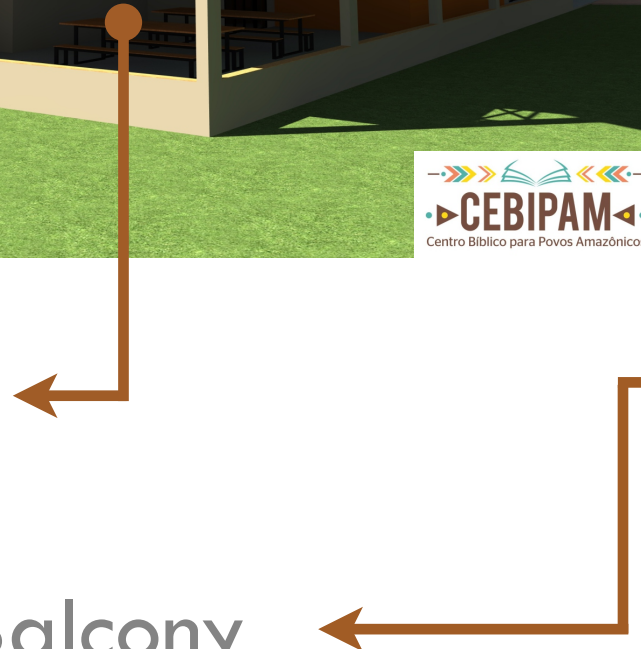

AMAZONAS - BRASIL



AMAZONAS - BRASIL



AMAZONAS - BRASIL



Office



Side Terrace



EXTERNAL VIEW

Side/Back

Part of the Building



AMAZONAS - BRASIL



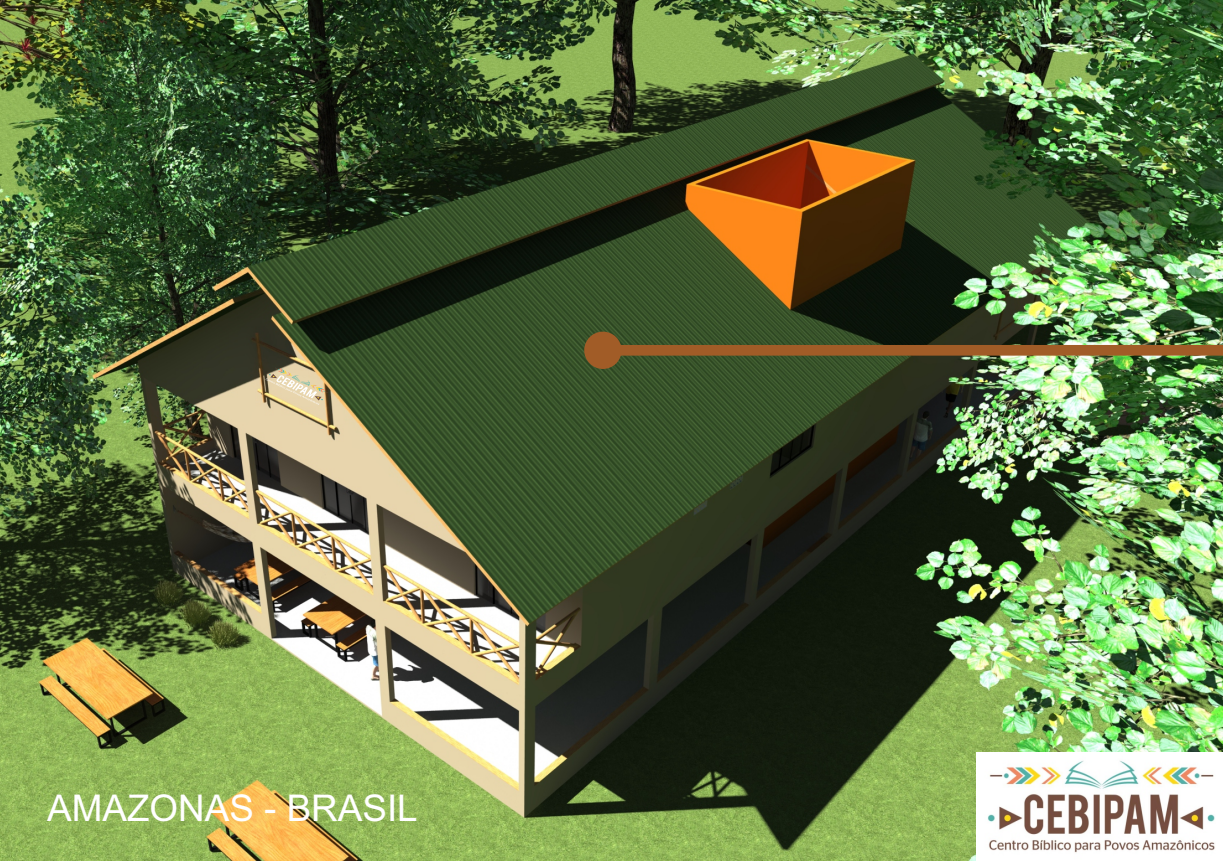

AMAZONAS - BRASIL



Building's Upper View

Dinning Hall



AMAZONAS - BRASIL





Hammock Dormitory

Capacity: 20 Hammocks





Main Classroom

Capacity for 50 Students



PARTNERSHIP IS FUNDAMENTAL

“I will venture to go... but remember that you must hold the ropes.” William Carey

“Missions is done with the feet of those who go, the knees of those who pray, and the hands of those who give.” Unknown



TOTAL AMOUNT \$US 80.000,00

- ▶ First Phase 5,000.00
 - Land's Acquisition (donated)
- ▶ First Phase 40,000.00
 - Foundation
 - Structure
 - Masonry and Roofing
- ▶ Second Phase 20,000.00
 - Surrounding Walls
 - Finishing
- ▶ Third Phase 15,000.00
 - Painting
 - Furnishing
 - Equipment

CEBIPAM BUILDING COST





Here is how **YOU** can help CEBIPAM to accomplish this building project:

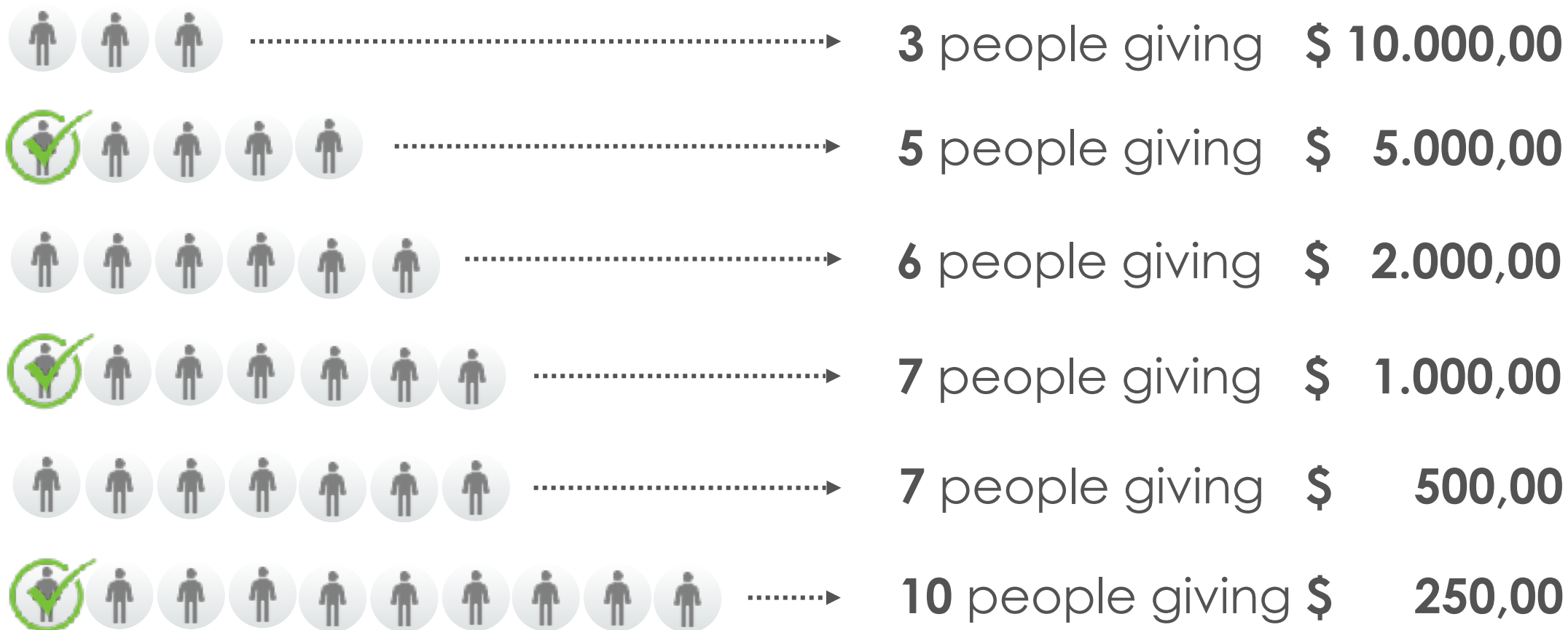

GOD

*Depends on
God's provision
for the
resources*

**BUILDING
CEBIPAM**

*The triangle of
PROVISION*

*Asks God if this
is the project
to invest*

**POSSIBLE
DONOR**

*Invites to
participate*



CEBIPAM

Centro Bíblico para Povos Amazônicos

Rua da Mangueira s/n
Comunidade Santo Antônio
Benjamin Constant, AM - Brazil
Email: info@cebipam.org

DONATIONS

Send checks to:
Allegro Solutions - 5535 Memorial Dr.
Ste. F-811 - Houston, TX 77007.
Make checks to: "Allegro Solutions"
include a note saying: CEBIPAM.001

For donations online, go to:
www.allegrosolutions.org/donate/CEBIPAM001

